

# Mori Pendant

12527 rA

AC Input

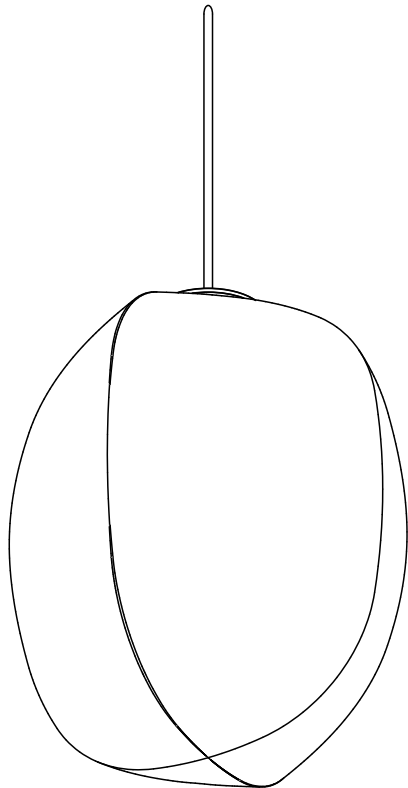

## CAUTION:

Before starting, turn off power at main circuit panel.

## ADVERTENCIA:

Antes de comenzar la instalación, apague la corriente en el tablero principal.

## ATTENTION:

Coupez l'alimentation avant de procéder à l'installation.



Calling for backup? Scan above to contact our team.

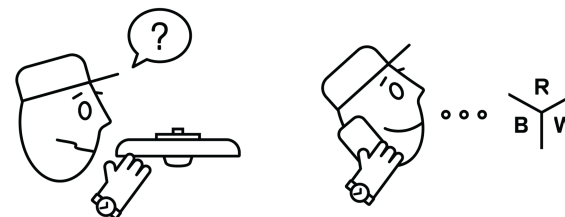

[www.RBW.com](http://www.RBW.com)

+1 212 388 1621

[support@RBW.com](mailto:support@RBW.com)

© RBW Studio LLC, 2013, 2020

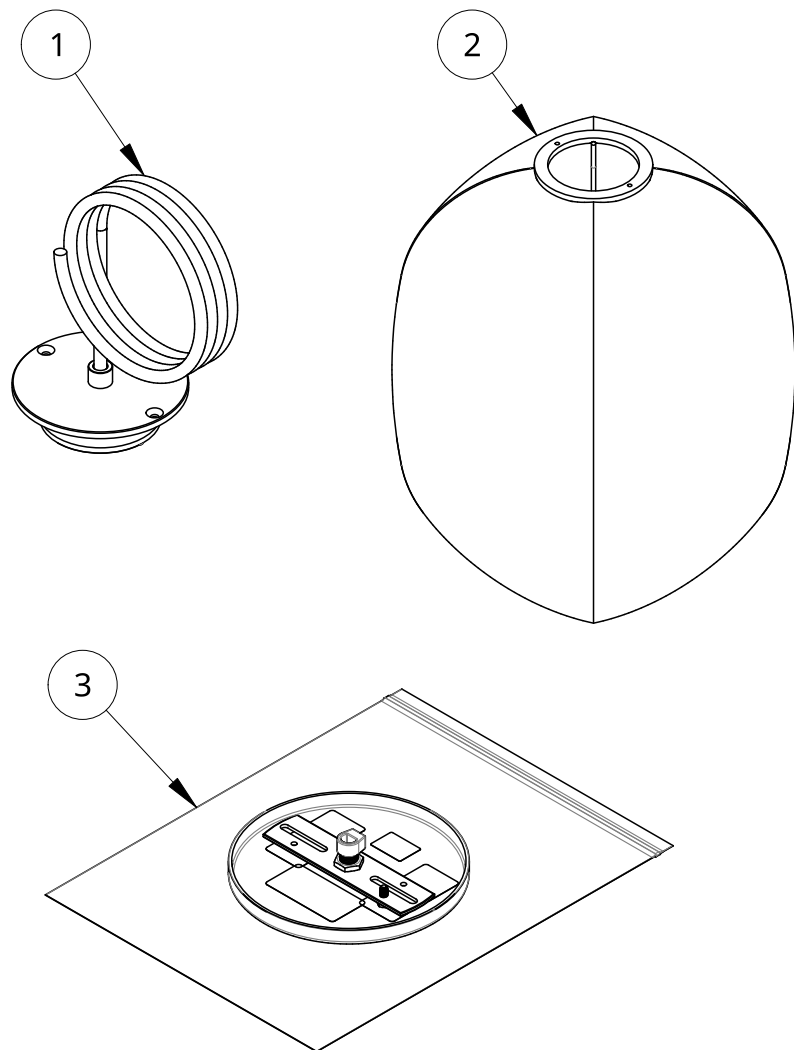

Item	Qty	Part number	Description
1	1	12436-PC20-27	Pendant Module Sub-Assembly 120 AB GES
2	1	12304	Mori Pendant Gourd
3	1	12612	CP09 Canopy Kit

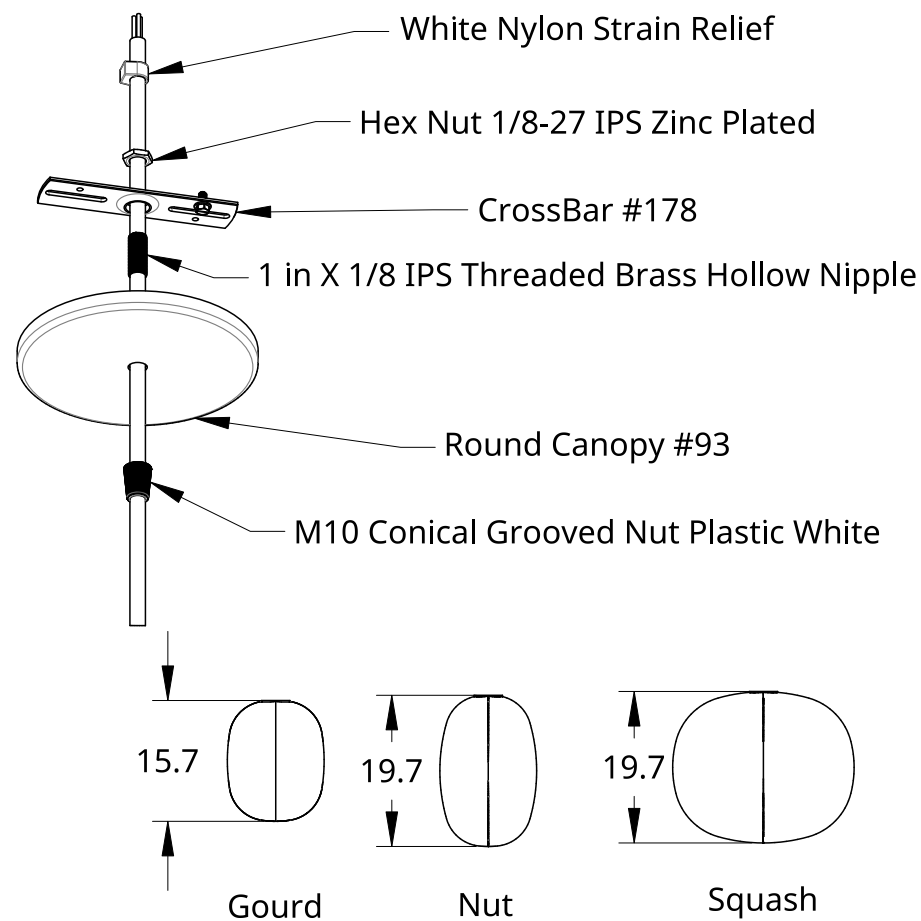

### Installation - Canopy

1. Thread Brass Nipple through the Crossbar and thread Hex Nut onto Brass Nipple.
2. Slide the Conical Nut, Round Canopy, Nipple, Crossbar, Hex Nut and Strain Relief over Power Cord.
3. Fasten Strain Relief at desired hang height by tightening the set screw.
4. Fasten Crossbar to the junction box.
5. Trim and strip excess power cord.
6. Connect power feed.
7. Raise Round Canopy and thread Conical Nut onto 1/8 IPS Nipple.

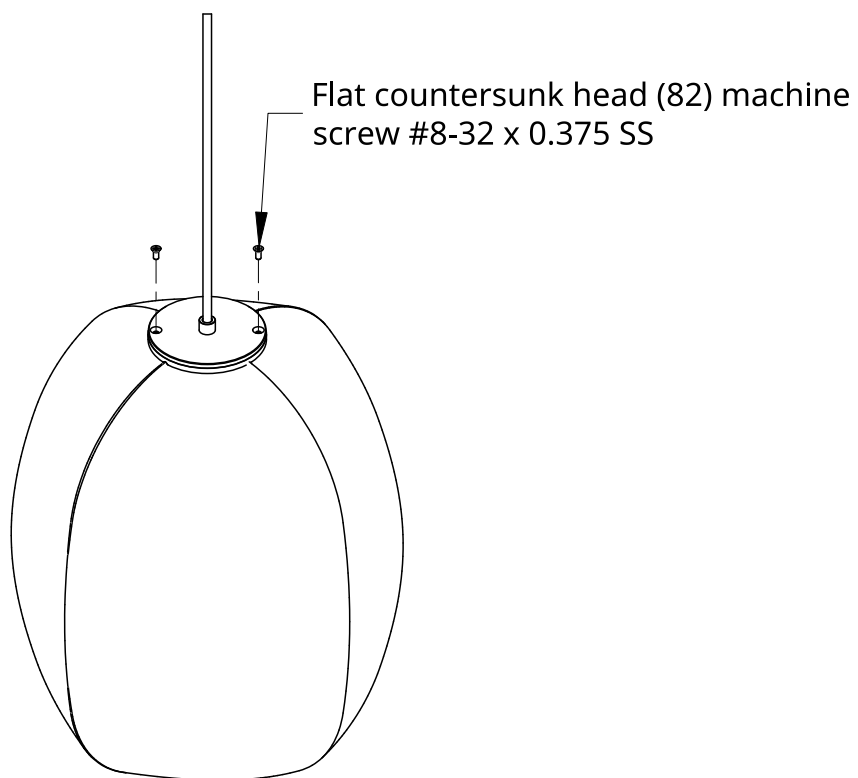

Page intentionally left blank

#### Installation - Shade

1. Raise Mori Shade up to Pendant Module.
2. Secure Shade to Pendant Module by fastening 2 #8-32 Flat head screws.
3. Congratulations! End of guide.